



ICE CUBE PLUS⁺ Personal Space Cooler

INSTRUCTION MANUAL



Please retain instructions for future reference.

SAFETY INSTRUCTIONS

When using electrical products, basic safety precautions should always be followed.

Check that the voltage indicated on the rating plate corresponds with that of the local network before connecting the product to the mains power supply.

Children younger than 3 years old should be kept away from the product unless continuously supervised.

Children aged from 3 years and less than 8 years should not plug in, regulate or clean the product or perform user maintenance.

Children aged from 8 years and people with reduced physical, sensory or mental capabilities or lack of experience and knowledge can use this appliance, only if it has been placed in its intended operating position and they have been given supervision or instruction concerning use of the appliance in a safe way and understand the hazards involved.

Children should not perform cleaning or user maintenance unless they are older than 8 years and supervised.

This is not a toy – children should be supervised to ensure they do not play with the product.

Always unplug the product and allow to cool fully after use and before any cleaning or maintenance.

Normal voltage is still present in this product as long as the product is connected to the electrical source.

If the power supply cord, plug or any part of the appliance is malfunctioning or if it has been dropped or damaged, cease using the product immediately to avoid potential injury.

This appliance contains no user serviceable parts, only a qualified electrician should carry out repairs.

Improper repairs may place the user at risk of harm.

Keep the product and its power supply cord out of the reach of children and away from heat or sharp edges that could cause damage. This includes any parts of the product that may become hot during use and other heat emitting products. Keep hands, fingers, hair and any loose clothing away from the rotating parts of the product.

Do not immerse the product in water or any other liquid.

Do not operate the product with wet hands.

Do not leave the product unattended whilst connected to the power supply or when in use.

Do not remove the product from the power supply by pulling the cord; switch it off and remove the plug by hand.

Do not use this product for extended periods of time.

Do not leave the product plugged in or operating overnight.

Do not use the product for anything other than its intended use.

Do not use this product outdoors.

Do not move the product whilst it is in use.

Do not shake the product.

Do not cover the product.

Do not put objects into any of the openings.

Do not clean the product with abrasive chemicals or materials such as scourers, as they may damage the product. This includes insecticide and chemical solvents.

Only lift the product with the carry handles provided.

Always use the product on a flat, stable surface.

Use of an extension cord with the product is not recommended.

This product should not be operated by means of an external timer or separate remote control system, other than that supplied with this product.



This product is intended for domestic use only. It should not be used for commercial purposes.

WARNING: If a strong odour is emitted from the product, turn the unit off and unplug it from the mains power supply. Should the product fall or be pushed over while there is water in the tank, it must be unplugged from the mains outlet immediately as a first action. The unit should be righted and dried thoroughly before it is used again.

CARE AND MAINTENANCE

Always wait until the air cooler has stopped completely and unplug it from the power supply before performing any cleaning or user maintenance.

Wipe the air cooler with a soft, damp, lint-free cloth and allow to dry thoroughly.

Do not immerse the air cooler in water or any other liquid.

STEP 1: The water tanks must be drained of any water after each use. To do so, carefully open the access doors and pull the water tanks out from the air cooler. Unscrew the caps and tip away any excess water. Once the water tanks have been drained, shake to remove any excess, and leave to dry with the caps off.

STEP 2: To clean the filter, lift the filter block up and slide it out of one of the sides of the air cooler main unit. Remove any loose fibres by hand and rinse with cool, clean water. Leave the filter block to air dry if not using the air cooler immediately after carrying out maintenance. Alternatively, place the filter into a dishwasher at 35 °C for approx. 35 minutes and then leave to air-dry.

STEP 3: Before replacing the water tanks and filter block, wipe the inside of the air cooler with an absorbent cloth to remove any excess water from the water reservoir (located in the base of the unit). Any limescale deposits in the air cooler can be removed with a soft, damp cloth and mild detergent.

STEP 4: Wipe the exterior of the air cooler with a soft, damp cloth and dry thoroughly. The filter block and water tanks can be replaced once dried thoroughly.

Do not use flammable liquid, abrasive cleaning solvents, polishes or scouring pads to clean the air cooler as this may cause damage.

NOTE: Clean the air cooler and all of its parts regularly to reduce the risk of limescale and bacteria forming.

If you notice mould on the filter block or a musty smell coming from the unit remove the filter block from the air cooler and fully immerse in a solution of equal parts water and white vinegar. Allow the filter block to soak for 45-60 minutes before rinsing thoroughly in warm water then allow to air dry naturally.

It is advised that the filter is replaced every 6-12 months. Contact our customer service team to order a new filter at customersupport@kleeneze.com

DESCRIPTION OF PARTS

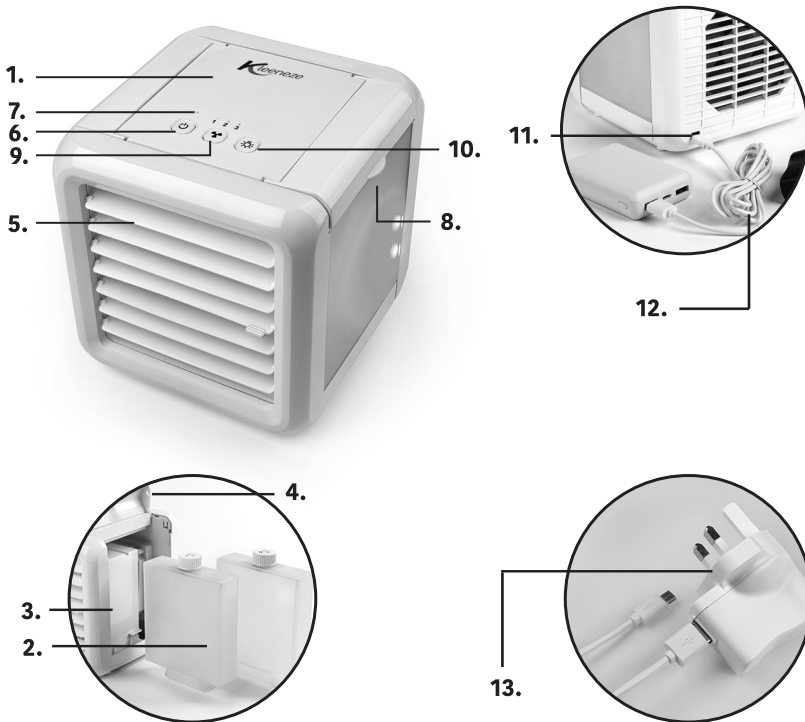

- | | |
|--|---|
| <ul style="list-style-type: none"> 1. Ice Cube Plus+ Personal Space Cooler main unit 2. Water tank(s) 3. Filter block 4. Water tank access doors 5. Horizontal grill 6. Power button | <ul style="list-style-type: none"> 7. Indicator light(s) 8. Mood lights 9. Cooling speed button (🌀) 10. Mood light button (☀️) 11. Micro USB port 12. USB power cable 13. Mains to USB adaptor |
|--|---|

INSTRUCTIONS FOR USE

The air cooler is designed to be operated using a USB power source. It can be used with or without water, but for optimum cooling it is recommended to fill the air cooler water tanks with water following the instructions below.

FILLING THE ICE CUBE PLUS⁺ PERSONAL SPACE COOLER

The air cooler must be switched off and unplugged from the power supply before filling the water tanks.

STEP 1: Open the water tank access doors and pull the water tanks up and away from the air cooler.

STEP 2: Remove the filter block by lifting and sliding it sideways out of the air cooler and run it under a steady stream of cool, clean water so that the filter becomes fully wet. Shake gently to remove the excess and replace the filter block into the air cooler.

STEP 3: Remove the water tanks, unscrew the caps and fill them to the brim with cool, clean water. Replace the caps and slide the water tanks back into position so that they are seated properly. The valves in the caps should begin to release the water into the air cooler. This will fill the reservoir in the base of the air cooler main unit with water.

STEP 4: Carefully close the water tank access doors.

NOTE: For additional cooling, the water tanks can be filled to the indicated line and placed into the freezer for 8 hours. When the tanks have fully frozen, they can be topped up to the brim with cool, clean water and then inserted into the air cooler following the instructions in the section entitled 'Filling the Ice Cube Plus⁺ Personal Space Cooler'.

The wet filter block can be placed in the freezer with the water tanks upright for 8 hours until frozen to increase the cooling effect.

Do not freeze the water tanks with the caps on – this could cause damage to the valves and to the water tanks.

CAUTION: Do not fill the air cooler with any liquid other than cool, clean water. Do not use any additives in the water.

USING THE ICE CUBE PLUS⁺ PERSONAL SPACE COOLER

STEP 1: Plug in and switch on the air cooler at the desired power supply. Press the power button to turn on the air cooler.

STEP 2: The desired cooling speed can be selected by pressing . Cycle through the speeds numbered 1-3, 3 being the strongest cooling speed. The indicator lights will show the speed selected.

STEP 3: Turn on the mood light by pushing '☀️'. Cycle through the seven colours by repeatedly pressing '☀️' until the desired colour setting has been selected.

STEP 4: To regulate the direction of the air airflow, manually adjust the horizontal grills on the front of the air cooler.

STEP 5: Turn off the air cooler by pressing the power button.

NOTE: Always remove the excess water and allow the air cooler to dry after each use to avoid a build-up of limescale and bacteria.

The air cooler is not designed to significantly reduce the room temperature but will provide a localised cool breeze for a small space.

When positioning the air cooler, do not lift it by the front panel.

Keep the air cooler level when filled with water to avoid spills. This is due to the water reservoir which is located in the base of the unit.

It is normal to see water droplets form on or around the tanks. This is no cause for concern.

Simply wipe away the droplets with an absorbent cloth.

STORAGE

Drain the water tanks and allow the air cooler to cool before storing in a cool, dry place. Carefully coil the power cable to avoid damage during storage

TROUBLESHOOTING

| Problem | Possible Cause | Solution |
|--|---|---|
| The air blowing from the air cooler is insufficient. | <p>The cooling speed is set too low.</p> <p>The filter block is blocked.</p> | <p>Select a higher cooling speed by pressing 'SPEED' until the desired cooling speed has been selected.</p> <p>Clean the filter block following the instructions in the section entitled 'Care and Maintenance'.</p> |
| The air cooler is not cooling the air. | <p>The water tanks have not been filled with enough water.</p> <p>The water tanks have not been inserted correctly.</p> <p>The water tanks have not been left to freeze for long enough.</p> <p>Ambient humidity is high.</p> | <p>Fill the water tanks to the brim.</p> <p>Remove the water tanks and reinsert them, checking to make sure that the valve in the cap opens and releases the water correctly.</p> <p>Fill the water tanks to the indicated line with water and leave to freeze for approx. 8 hours before use.</p> <p>The air cooler will not be able to cool air due to the high humidity.</p> |

SPECIFICATIONS

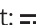
Product code: KL3139V2TE
 Input:  5 V

Output: 7 W
 Water tank capacity: 600 ml

Connection to the mains

Please check that the voltage indicated on the product corresponds with your supply voltage.

Important

As the colours in the mains lead of this appliance may not correspond with the coloured markings identifying the terminals in your plug, please proceed as follows:

The wires in the mains lead are coloured in accordance with the following code:

Blue Neutral (N)

Brown Live (L)

Green/Yellow Earth (⏚)

FOR UK USE ONLY - Plug fitting details (where applicable).

The wire coloured **BLUE** is the **NEUTRAL** and must be connected to the terminal marked N or coloured **BLACK**.

The wire coloured **BROWN** is the **LIVE** wire and must be connected to the terminal marked L or coloured **RED**.

The wire coloured **GREEN/YELLOW** must be connected to the terminal marked with the letter E or marked **⏚**.

On no account must either the **BROWN** or the **BLUE** wire be connected to the **EARTH** terminal (⏚).

Always ensure that the cord grip is fastened correctly.

The plug must be fitted with a fuse of the same rating already fitted and conforming to BS 1362 and be ASTA approved.

If in doubt consult a qualified electrician who will be pleased to do this for you.

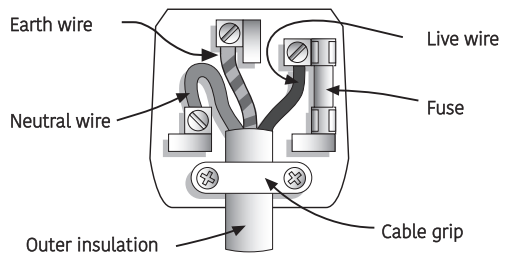

Non-rewireable mains plug

If your appliance is supplied with a non-rewireable plug fitted to the mains lead and should the fuse need replacing, you must use an ASTA approved one (conforming to BS 1362 of the same rating).

If in doubt, consult a qualified electrician who will be pleased to do this for you.

If you need to remove the plug - **DISCONNECT IT FROM THE MAINS** and then cut it off the mains lead and immediately dispose of it safely. Never attempt to reuse the plug or insert it into a socket outlet as there is a danger of an electric shock.

**UP Global Sourcing UK Ltd.,
UK. Manchester OL9 0DD.
Germany. 51149 Köln.**

If this product does not reach you in an acceptable condition please contact our Customer Services Department at www.kleeneze.com

Please have your delivery note to hand as details from it will be required.

If you wish to return this product please return it to the retailer from where it was purchased with your receipt (subject to their terms and conditions).

Guarantee

All products purchased as new carry a manufacturer's guarantee; the time period of the guarantee will vary dependent upon the product. Where reasonable proof of purchase can be provided, Kleeneze will provide a standard 12 month guarantee with the retailer from the date of purchase. This is only applicable when products have been used as instructed for their intended, domestic use. Any misuse or dismantling of products will invalidate any guarantee.

Under the guarantee, we undertake to repair or replace free of any charge any parts found to be defective. In the event that we cannot provide an exact replacement, a similar product will be offered or the cost refunded. Any damages from daily wear and tear are not covered by this guarantee, nor are consumables such as plugs, fuses etc.

Please note that the above terms and conditions may be updated from time to time and we therefore recommend that you check these each time you revisit the website.

Nothing in this guarantee or in the instructions relating to this product excludes, restricts or otherwise affects your statutory rights.

DISPOSAL OF WASTE BATTERIES AND ELECTRICAL AND ELECTRONIC EQUIPMENT



This symbol on the product, its batteries or its packaging means that this product and any batteries it contains must not be disposed of with household waste. Instead, it is the user's responsibility to hand this over to an applicable collection point for the recycling of batteries and electrical and electronic equipment. This separate collection and recycling will help to conserve natural resources and prevent potential negative consequences for human health and the environment due to the possible presence of hazardous substances in batteries and electrical and electronic equipment, which could be caused by inappropriate disposal. Some retailers provide take-back services which allow the user to return exhausted equipment for appropriate disposal. **It is the user's responsibility to delete any data on electrical and electronic equipment prior to disposal.** For more information about where to drop batteries, electrical and electronic waste off, please contact the local city/municipality office, household waste disposal service, or the retailer.

3 YEAR
Guarantee*

*To be eligible for the extended guarantee, go to guarantee.upgs.com/kleeneze and register your product within 30 days of purchase.



Manufactured by:
UP Global Sourcing UK Ltd.,
UK. Manchester OL9 0DD.
Germany. 51149 Köln.

www.kleeneze.com

©Kleeneze Trademark. All rights reserved.

MADE IN CHINA.

CD050919/MD230222/V2

