

Important safety

Please read carefully

Please retain instructions for future reference.

SAFETY INSTRUCTIONS

- When using electrical appliances, basic safety precautions should always be followed.
- Check that the voltage indicated on the rating plate corresponds with that of the local network before connecting the appliance to the mains power supply.
- This appliance can be used by children aged from 8 years and above and persons with reduced physical, sensory or mental capabilities and knowledge, if they have been supervised/instructed and understand the hazards involved.
- Children shall not play with the appliance.
- Children should not perform cleaning or user maintenance, unless they are older than 8 and supervised.
- This appliance is not a toy.
- If the power supply cord, plug or any part of the appliance is malfunctioning or if it has been dropped or damaged, cease using the product immediately to avoid potential injury.
- This appliance contains no user serviceable parts, only a qualified electrician should carry out repairs. Improper repairs may place the user at risk of harm.
- Keep the appliance and its power supply cord out of the reach of children.
- Keep the appliance out of the reach of children when it is switched on or cooling down.
- Do not immerse the appliance in water or any other liquid.
- Do not leave the appliance unattended whilst connected to the mains power supply.
- Do not remove the appliance from the mains power supply by pulling the cord; switch it off and remove the plug by hand.
- Do not pull or carry the appliance by its power supply cord.
- Do not use the appliance for anything other than its intended use.
- Do not use any parts/accessories or adaptors other than those supplied with this appliance.
- Do not use this appliance outdoors.
- Do not use the appliance on leather, wax polished furniture or floors, vinyl or laminate floors, synthetic fabrics, velvet or other delicate, steam-sensitive materials.
- Do not use the appliance on any unsealed hard floor surfaces or surfaces that have been treated with wax, as the sheen may be removed by the heat and steam action. It is always recommended to test an isolated area of the surface to be cleaned before proceeding.
- Do not touch any sections of the appliance that may become hot during use, as this could cause injury.
- Do not direct steam at people or animals or towards equipment containing electrical components, such as the interior of ovens.
- Use of an extension cord with the appliance is not recommended.
- This appliance should not be operated by means of an external timer or separate remote control system.
- This appliance is intended for domestic use only. It should not be used for commercial purposes.



CAUTION: The appliance emits very hot steam; always exercise extreme caution during use.



WARNING: Danger of scalding.

**UK
CA CE**

EN | Disposal of Waste Batteries and Electrical and Electronic Equipment



This product is labelled with this crossed out wheel bin symbol in accordance with European Directive 2012/19/EC to indicate that it must not be disposed of with your other household waste. Due to the presence of hazardous substances, mixtures or components, electrical and electronic devices that are not subject to selective sorting are potentially dangerous to the environment and human health. Please check your local city office or waste disposal service for the return and recycling of this product.

Manufactured by:
Ultimate Products UK Ltd.,
Victoria Street, Manchester OL9 0DD. **UK.**
Ultimate Products Europe Ltd.,
19 Baggot Street Lower, Dublin D02 X658. **ROI.**

MADE IN CHINA.

CD181124/MD000000/V1



NOTE: Ensure the spray hose is free from any blockages or debris. The dirty water tank filter sponge should be cleaned regularly to ensure it remains free of blockages or debris. Replace the sponge as needed to maintain optimal performance.

Hints and tips

1. When cleaning an area, move the furniture away. If this is not possible, place aluminium foil under the legs of the furniture. This will prevent any wood finishes from running and staining the surface.
2. Stain removal varies with the type of stain, the time passed before removal and the carpet type/material. Heavily soiled areas may have to be pre-treated before using the spot cleaner.
3. For best cleaning results, use a slow and steady forwards and backwards motion.
4. For multi-coloured carpets, test every colour to ensure that they do not bleed.

Troubleshooting

Problem	Possible cause	Solution
The spot cleaner will not suck up water.	The dirty water tank max. fill line has been exceeded.	Follow the instructions in the section entitled 'Emptying the dirty water tank' .
Solution is not dispensing from the detergent compartment.	The water tank is not fitted securely.	Follow the instructions in the section entitled 'Filling the clean water tank' .
The carpet is too wet.	Too much detergent has been used on the carpet.	Use less detergent on the carpet area. Run the spot cleaner over the carpet, without pressing the spray button, to vacuum excess water.

Storage

Empty both water tanks before wrapping the power cord around the cord storage hooks. Check that the spot cleaner is clean and dry before storing in a cool, dry place.

Specifications

Product code: KL02089
 Input: 220–240 V ~ 50–60 Hz
 Output: 330 W
 Clean water tank capacity: 800 ml
 Dirty water tank capacity: 500 ml
 Waterproof level: IPX4

User manual

Spot cleaner

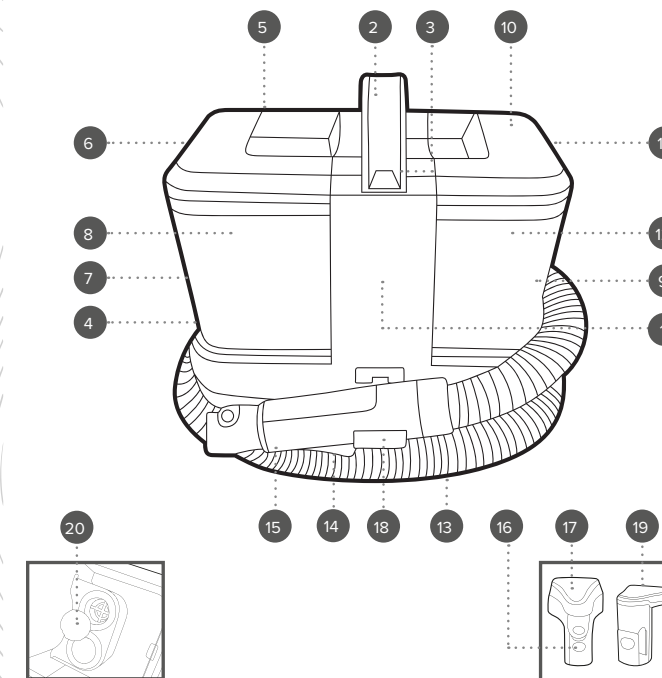

- | | |
|-------------------------------------|-------------------------------------|
| 1. Spot cleaner main unit | 11. Clean water tank clip |
| 2. Handle | 12. Clean water tank max. fill line |
| 3. Power button | 13. Spray hose |
| 4. Dirty water tank | 14. Spray trigger |
| 5. Dirty water tank lid | 15. Spray nozzle |
| 6. Dirty water tank clip | 16. Brush attachment |
| 7. Dirty water tank max. fill line | 17. Brush cover |
| 8. Dirty water tank max. fill float | 18. Brush holder/storage hook |
| 9. Clean water tank | 19. Upholstery nozzle attachment |
| 10. Clean water tank lid | 20. Dirty water tank filter sponge |

Manufactured by:
 Ultimate Products UK Ltd.,
 Victoria Street, Manchester OL9 0DD. **UK.**
 Ultimate Products Europe Ltd.,
 19 Baggot Street Lower, Dublin D02 X658. **ROI.**

Please retain instructions future reference.

Dos and don'ts

- DO:**
 Always consult the furniture or carpet manufacturer prior to using the spot cleaner to clean surfaces.
 Empty the dirty water tank after each use to maintain optimum performance of the spot cleaner.
 Fill the clean water tank following the guidelines of the chosen detergent manufacturer.
 Ensure the removable brush cover is fixed into place securely, prior to turning on the spot cleaner.
 Fill the clean water tank with detergent solution following the manufacturer's guidelines.
- DON'T:**
 Allow the dirty water tank to exceed the max. fill line.

Care and maintenance

- Before attempting any cleaning or maintenance, always switch off and unplug the spot cleaner from the mains power supply.
 Drain any remaining water from the clean and dirty water tanks.
 Wipe the spot cleaner with a soft, damp cloth and dry thoroughly.
 Do not use harsh or abrasive cleaning detergents or scourers.
 Ensure that the brush attachment, upholstery nozzle attachment and spray hose are free from any blockages, dirt or debris.

Instructions for use

Assembling the spot cleaner

- STEP 1:** Switch off and unplug the spot cleaner from the mains power supply before fitting any parts onto the spot cleaner main unit.
STEP 2: Slide the brush attachment or upholstery nozzle attachment onto the spray hose and secure it by pushing it until it clicks into place.
STEP 3: Attach the storage hooks into the clip on the rear of the spot cleaner main unit by pushing it down into place.



NOTE: Ensure all parts are securely attached and there are no loose parts.

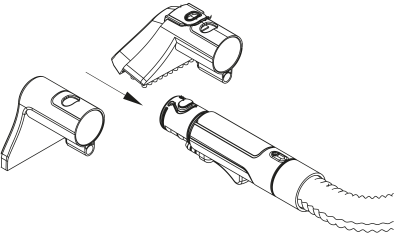

Mixing a cleaning solution

- STEP 1:** Predilute the cleaning solution following the guidelines on the detergent bottle.
STEP 2: Test on a discrete area prior to cleaning. This will ensure that the cleaning solution will not cause the colours to bleed in the area being cleaned. To do this, dampen a white cloth with the cleaning solution and warm water. On a small hidden area of the carpet, gently rub the surface.
 Wait for approx. 10 minutes then check for colour bleeding. If the cloth remains clean, the cleaning solution can be used on the tested surface.
 Always consult the upholstery or carpet manufacturer's guidelines prior to using the spot cleaner.
 It is recommended to use a cleaning solution recommended for spot cleaners with this product.



CAUTION: The use of cleaning formulas which contain lemon, pine oil, vinegar or bleach may damage the spot cleaner and void the warranty. Chemical spot cleaners or solvent-based soil removers should also not be used.

Filling the clean water tank

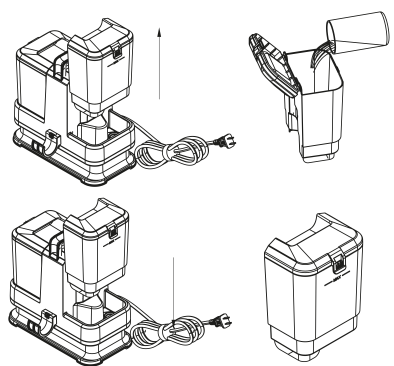

- STEP 1:** Remove the clean water tank by lifting it away from the spot cleaner main unit.
STEP 2: Open the clean water tank by lifting the clean water tank cap. Fill the clean water tank with warm water (max. 40 °C) or diluted detergent (following the manufacturer's guidelines), checking that the max. fill line of the tank is not exceeded.
STEP 3: Close the water tank lid by clipping it into place, then replace the water tank into the spot cleaner main unit. The flat edge of the water tank should align with the flat edge of the spot cleaner main unit.
STEP 4: Ensure the brush cover is firmly attached to the brush attachment. Failure to do so will result in a reduction in suction from the spot cleaner.
STEP 5: Slide the brush attachment onto the spray hose and secure it by pushing it until it clicks into place.



NOTE: Do not use the spot cleaner without the water tanks in position.



CAUTION: Do not attempt to remove/replace the water tank whilst the spot cleaner is turned on. Do not press the spray trigger if the clean water tank is empty.



WARNING: Do not use any foaming or disinfectant solution with the spot cleaner, as this could cause damage.

Using the spot cleaner

- For best cleaning results, use the spot cleaner immediately after the surface has been stained or a spill has occurred.
 The **brush attachment** is designed for targeted cleaning of specific stains and spills on carpets, upholstery and other fabric surfaces.
 The **upholstery nozzle attachment** is designed for cleaning delicate surfaces like velvet, ensuring gentle care while cleaning.
STEP 1: Vacuum or sweep the area to be cleaned; the spot cleaner is not designed to pick up debris.
STEP 2: Fill the clean water tank following the instructions in the section entitled **'Filling the clean water tank'**.

- STEP 3:** Place the spot cleaner on a flat, stable surface close to the affected area before plugging in and switching on the spot cleaner at the mains power supply.
STEP 4: Turn on the spot cleaner by pressing the power button.
STEP 5: Point the spray nozzle attachment at the stain and press the spray trigger to pre-treat the carpet. It is recommended to allow the detergent solution to soak into the surface for five minutes prior to cleaning commencing.
STEP 6: Move the brush attachment backwards and forwards over the affected area to work the cleaning solution into the surface.
STEP 7: Pull the brush attachment backwards over the area to remove the dirty solution from the carpet. Repeat this process as many times as necessary.
STEP 8: Once finished, press the power button to turn off the spot cleaner.



NOTE: The surface to be cleaned can be pre-treated with detergent multiple times if necessary.



CAUTION: The surface may be damp after the spot cleaner has been used. Allow to dry completely before walking on the surface. Do not allow the spray to come into contact with the eyes or face. Failure to do so may result in injury.



WARNING: Do not allow the dirty water tank to exceed the dirty water tank max. fill mark; this will cause the max. fill float to activate and the spot cleaner suction to cut off.

Emptying the dirty water tank

- STEP 1:** Ensure the spot cleaner is switched off and is not plugged into the mains power supply.
STEP 2: Lift the dirty water tank away from the spot cleaner main unit.
STEP 3: Open the dirty water tank by unclipping and lifting the dirty water tank cap.
STEP 4: Empty the dirty water into a sink and rinse the dirty water tank and the max. fill float under clean running water.
STEP 5: Allow to dry thoroughly before replacing the dirty water tank into the spot cleaner main unit.
STEP 6: Refit the dirty water tank back into the spot cleaner main unit. Close the dirty water tank lid by clipping it into place. The flat edge of the dirty water tank should align with the flat edge of the spot cleaner main unit.



NOTE: It is recommended to empty the dirty water tank after every use to maintain optimum performance and to prevent the build-up of undesirable odours.

Max. fill safety float

If the liquid in the dirty water tank exceeds the max. fill mark, the max. fill float in the dirty water tank will stop the suction of the spot cleaner. This will cause the motor to work at a higher speed which will be audibly different to regular use and this can cause the spot cleaner to stop suctioning. At this point, the spot cleaner should be switched off and the dirty water tank emptied following the instructions in the section entitled **'Emptying the dirty water tank'**. After this, it is safe to resume.

Cleaning the spot cleaner

- The brush cover on the spot cleaner can be removed for easy cleaning of any dirt or debris.
STEP 1: Remove the brush attachment from the extension hose. Lift the clip at the base of the brush cover and lift it away from the spot cleaner main unit.
STEP 2: Wash the brush cover in warm, soapy water and allow to dry thoroughly.
STEP 3: Replace the brush cover by aligning the loops on the cover with the indents of the brush attachment and pushing the cover into place.